

WARNIGN

- 1.Tighten screws firmly, but do not over tighten. Over tightening can damage the screws, greatly reducing their holding power.
- 2.Make sure that mounting screws are anchored into the center of the studs. Use of "edge to edge" stude finder is highly recommended.

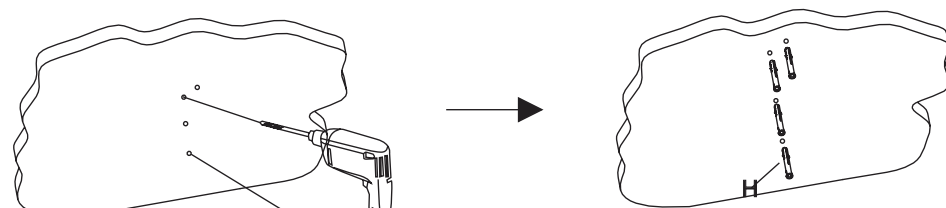

Diameter=8mm
Depth=50mm

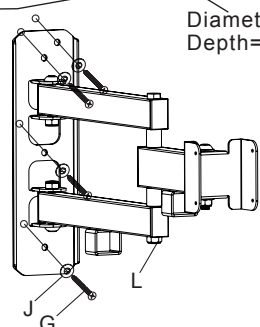

Step 1:Mounting the wall board to the studs. Drilling in the wall then put the 8x50 Concrete Anchor (H) in the holes, And fix the wall board to the wall by matching the ST6X50 Lag bolt(G) and the Ø6.5x18x1.5 Spacer (J) as above / left fig. Keep the bubble level in horizontal.

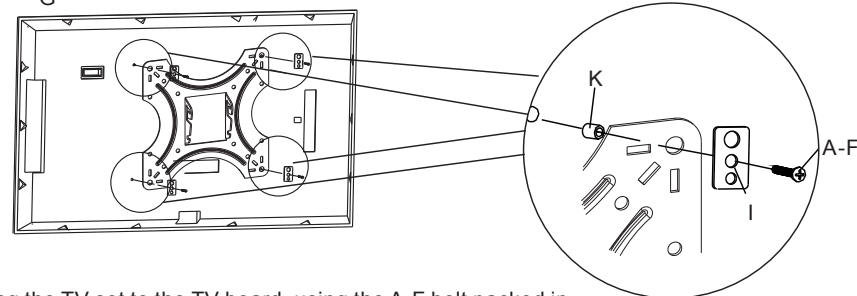

Step 2:

Mounting the TV set to the TV board, using the A-F bolt packed in accessories package to mount the screen to the TV board. Put the screw (A-F) into the Spacer (I), then fix them to TV set mounting holes as shown in the fig. Above.

Step 3:Put the well mounted TV board (M) with screen to the wall board (L). Finally tight the lock screw.

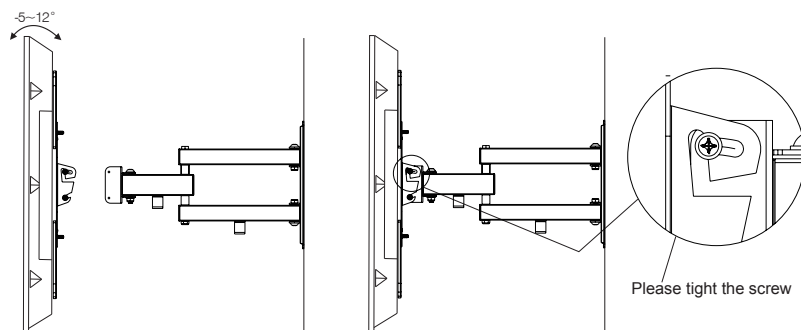

Please tight the screw



INSTALLATION INSTRUCTIONS

MODEL: TV-MOUN-B-SINGLE-927ST

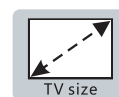
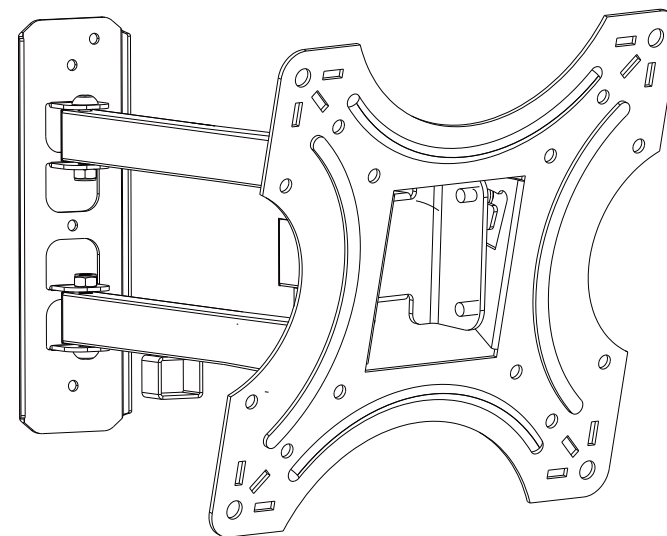

17"~42"



200X200mm



40Kgs

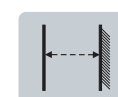

70-400mm

! WARNING

1. Do not begin to installation of the product on you have read and understand the instructions and warnings contained in this installation sheet. If you have any questions regarding any of the instruction or warning, Please contact your local distributor.
2. Please refer to manufacture' s installation guide recommendation for required distance from wall to avoid risk of property damage.
3. This product should only be installed by someone of good mechanical aptitude, with experience and basic building, and fully understands.
4. Make sure that the supporting surface will safely support the combined load of the equipment and all attached hardware an components.
5. Never exceed the Maximum Load Capacity.
6. If mounting to wood wall studs ,make sure that mounting screws are anchored into the center of the studs Use of an " edge to edge" stud finder is highly recommended.
7. This product intended for indoor use only. Use of this product outdoors could lead to product failure and personal injury.

Parts list

Parts name	Parts quantity	Index
Bolt M5x16	4	A
Bolt M5x30	4	B
Bolt M6x16	4	C
Bolt M6x30	4	D
Bolt M8x16	4	E
Bolt M8x30	4	F
Lag bolt St6x50	4	G
Concrete anchor 8x50	4	H
Spacer with 3 holes	4	I
Ø6.5x18x1.5 Spacer	4	J
Ø8.5x18x15 Washer	4	K
wall board	1	L

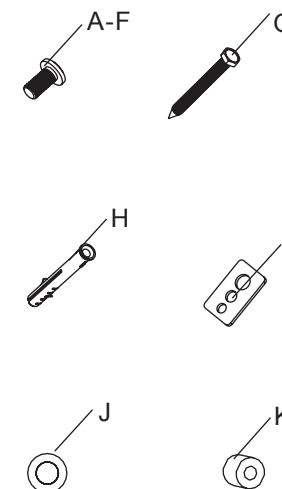

Steps of installation:

